

# Whisper Mountain Camp | Building the Vision as We Proclaim Christ to teens and adults

## OPPORTUNITIES TO MAKE A DIFFERENCE

Webster defines “Opportunity” as a set of circumstances that makes it possible **to do something**. **Together we are able to do more and reach more teens + adults for Christ**. Whisper Mountain Camp + Retreat is a non-profit and non-denominational Christian organization supported through individuals just like you! Below are some **OPPORTUNITIES FOR YOU TO JOIN US in doing something to make a difference in the lives of others**. Are you ready to do something with Whisper Mountain?

## OPPORTUNITIES TO FILL A NEED

**Amazon makes it easy!** Check out our **Amazon Wish List** to shop online and have donations delivered directly to our office. Contact us at [info@whispermountain.org](mailto:info@whispermountain.org) regarding any of the wish list items below. **Bold imprint items are greatest priority.**

### Temporary Housing Need for Kitchen Cook for Summer 2024

- Do you have a Tiny House or Motorhome that can be used at WM Property from May 1 – Aug 15? Let’s Talk!

### Audio/Visual Equipment

- **Sony Alpha a6400 Camera Kit with Video capabilities**

### Appliances

- Heavy Duty Lg Capacity Stack Electric Washer/Dryer Set
- **Alto Shaam Vector F4 Multifunction Oven Unit (\$14,000)**

### Emergency - Black Out Supplies

When electric power fails WM Camp has NO well, NO running water, NO toilets or lights! That’s a BIG problem! To help function during occasional power failures the great need:

- **Kohler/Generac Standby automatic backup generator for Well/Septic for 200 amp panel to run on LP Gas**
- Kohler/Generac Standby automatic backup generator for Refrigerators/Freezers
- Coleman Propane Lanterns or similar
- Coleman Quad LED Battery Lanterns or similar

### First Aid Supplies

- Nebulizer Breathing Treatment Machine
- Wound clean spray, Isopropyl Alcohol, Hydrogen Peroxide
- Benadryl Liquid & Tablets, Ibuprofen, Tylenol, Aleve
- Cortizone-10 Cream

### General Need Items

- **Bug Spray for Gnats & Chiggers**
- **Sun Screen**
- **Wet Wipes**
- **Disinfectant Wipes**
- **Lighters for campfire and candles**
- Gift Cards for Amazon, Walmart, and Sam’s
- **Batteries - AAA, AA, C, D and 9V**

### Grounds & Maintenance

- **Highwood Benches – Lifetime all-weather poly-lumber Lehigh Garden Bench in Harbor Gray Color – various sizes**
- Gift Cards for ACE Hardware, Lowes, Home Depot
- Grass Seed/Lime Pellets/Fertilizers/Weed Killer
- Weed block rolls + Mulch

### Janitorial Needs

- Trash Bags: 44 Gallon/13 Gallon/3 gallon
- Laundry – HE Detergent
- Laundry Prewash Spray
- Grease Lightening Cleaner Gallon
- Simple Green Cleaner Gallon
- Gift cards for ACE Hardware, Lowes, Home Depot or Tractor Supply

### Office Basics

- **Case of Bright White Copy Paper**
- **Reams of copy paper in variety of summer colors**
- **US Postal Forever Letter Postage Stamps**
- **Coffee and Tea for staff -Bulk and K-cups**
- **Dymo 1-1/2” x 3-1/2” Address Labels**
- **Dymo “LT” White Plastic Label Refill 1/2”x 13’**
- **White legal writing pads of paper**

### Summer Program Needs

- **New Believer Gift Bibles - ESV Student Study Bibles**
- **5,000 - 3x5 Note Cards (Used for Camper Encouragement Notes)**
- **Small paper bags (camper encouragement bags) 600+ needed**
- **Letter sized legal pads (colors are more fun!)**
- **Legal Sized Envelopes for camper letters**
- Archery: Easton Genesis 30” Aluminum Arrows (any colors)
- Tiki torch lights & Fluid w citronella for Gnats/Bugs
- **Heavy Duty Canopy Cover: 10’ x 20’ or 12’ x 20’**
- **Storage Tubs – Clear Large Heavy Duty – 8+ needed**
- Campers’ Personal hygiene items (when they forget to pack ☺): (toothbrush/toothpaste/comb/small individual shampoo/conditioner/bath soap)

### Summer Staff

- **GIFT CARDS:** McDonald’s, Wendy’s, Subway, Ingles, Walgreens, Dollar General, Family Dollar, Kin Coffee Shoppe
- **Frogg Togg Neck Towels, Assorted Colors (Great for hot summer days)**
- **12 Battery Operated Alarm Clocks + batteries**

### Vehicles + Machines - Nearly New or great working order

- 4 x 4 Kawasaki Mule 4010 Utility Vehicle
- **Kubota 40HP+ Tractor w/front loader + 3-point hitch**
- Small SUV Vehicle for camp grocery transfer + supply pick up and for marketing and ministry visit trips
- 4-wheel drive work truck – good condition with lower mileage to replace older camp work truck
- Gasoline Gift Cards (Shell, BP, Wal-Mart or Sam’s Club)

# Whisper Mountain Camp | Building the Vision as We Proclaim Christ to teens and adults

## OPPORTUNITIES TO JOIN A TEAM

We know it's impossible for everyone to physically come to Volunteer or Serve with us...but there are other important ways to be part of what God is doing at Whisper Mountain Camp.

### PRAYER WARRIORS - Empowering kingdom growth!

We invite you to join the prayer force by entering the throne room on behalf of the teens, their leaders, our staff and the ministry overall. We honestly couldn't do this without the faithfulness of our prayer warriors lifting this ministry up in this way.

### TEAM TEN - Give monthly online to impact many for eternity!

It's amazing what can be done when many team-up and give just a little! Your commitment to give \$10 or more each month can have a big impact to help grow and expand the vision of the ministry while we reach and teach more about a personal relationship with Christ. Sign up online for recurring donation to avoid the monthly payment.



## OPPORTUNITIES TO LEND A HAND

Keeping WM Campus maintained is a full-time job. Doing that along with ministry work seems impossible without the help of others. During a few select weeks of each spring, fall we are able to have people join us in doing specific projects. If you and a small group of hard-working individuals are interested in helping in a big way, let's talk about how to make it happen.

During Summers, due to limited accommodations and time, our only helping hands needed include two areas and each requires a minimum of one (1) week commitment:

- Assist WM Kitchen Staff to prep, serve meals and clean up after meals for camp meals while serving Mon-Fri only.
- Assist in grounds work of grass-trimming, weed pulling, misc. maintenance & trail clean-up while serving Mon-Fri only.

HAVE AN RV? RV spaces are available and helps frees up our limited accommodations!

### Current Projects: Help with Funding and/or Labor Teams

1. **Lumberjack tree & spring clean-up scheduled for 03/23/2024**
2. **Cabins & Bathhouse:** Labor + materials to replace rotted log siding w/cement-board siding and paint. (Cabins 5-6 complete)
3. **Hub:** Funding to remove old metal roof + install new roof
4. **Landscape:** Clean + Freshen Up Cabins & Creekside \$500+
5. Install new set of Hammock Post Stand \$110
6. Covered Parking Roof for multiple Golf Carts & Mules

## OPPORTUNITIES TO SUPPORT WM STAFF

Our Staff missionary model allows Whisper Mountain to focus funds and resources toward ministry growth, remain debt free and keep our prices affordable. This model allows us to evangelize and to teach more teens as "we proclaim Him, admonishing and teaching everyone with all wisdom, so that we may present everyone fully perfect in Christ." Colossians 1:28 **All WM Full-time Staff have chosen to live simply and raise a portion of their mission support to cover their salaries.** God is faithful and continues to provide for our needs. Each staff member has personal sponsors that provide them with a **team who prays, encourages them and gives to their financial needs monthly or one-time.** If you would like to join the adventure of stepping out in faith along with us, we invite you to be a monthly sponsor of one or more of our full-time staff. For more information "Meet the Staff" on our website page.

## OPPORTUNITIES TO HELP US GROW

For 18 years now God's Vision for this ministry has been steadily taking place. WM's slow and steady growth continues, and is now experiencing "growing pains" in the existing facilities. Last summer the need became more evident that continued growth is necessary to make this ministry self-sustaining. The growth means we also need more usable space for groups and additional full-time staff. We continue to seek His direction and His faithful provision and His people to make it a reality.

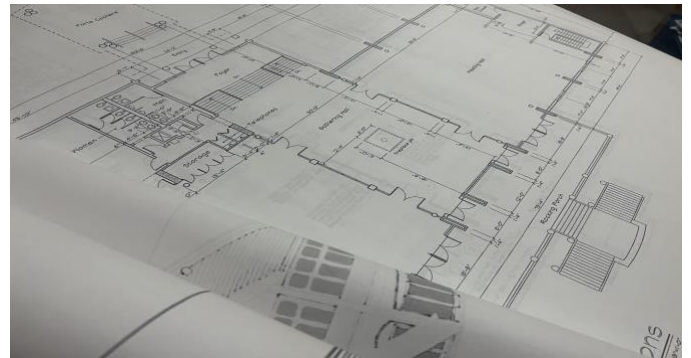

## NEXT UP - FIELD HOUSE BUILDING

**The "Field House" Multi-purpose building is being designed to hold larger Kitchen and Dining Hall, Worship Center, Katangelo Camp Store and Administrative Offices.**



**Phase #1 Site Clearing is complete!!**

**"In the works"**

**Phase #2 Planning/Architectural Design/ Fundraising/Permits Phase**

Once complete, this will free up the current office for new staff housing; the current HUB for activity room and concessions and existing worship center for activity room for rain days and creating small group meeting area. Every building utilized for its best use.